

**SM-126592**

**Motor bracket SE30/40S2, galvanic  
isolation**

**Spare parts (valid from 2022-01-11)**



**SLEIPNER**

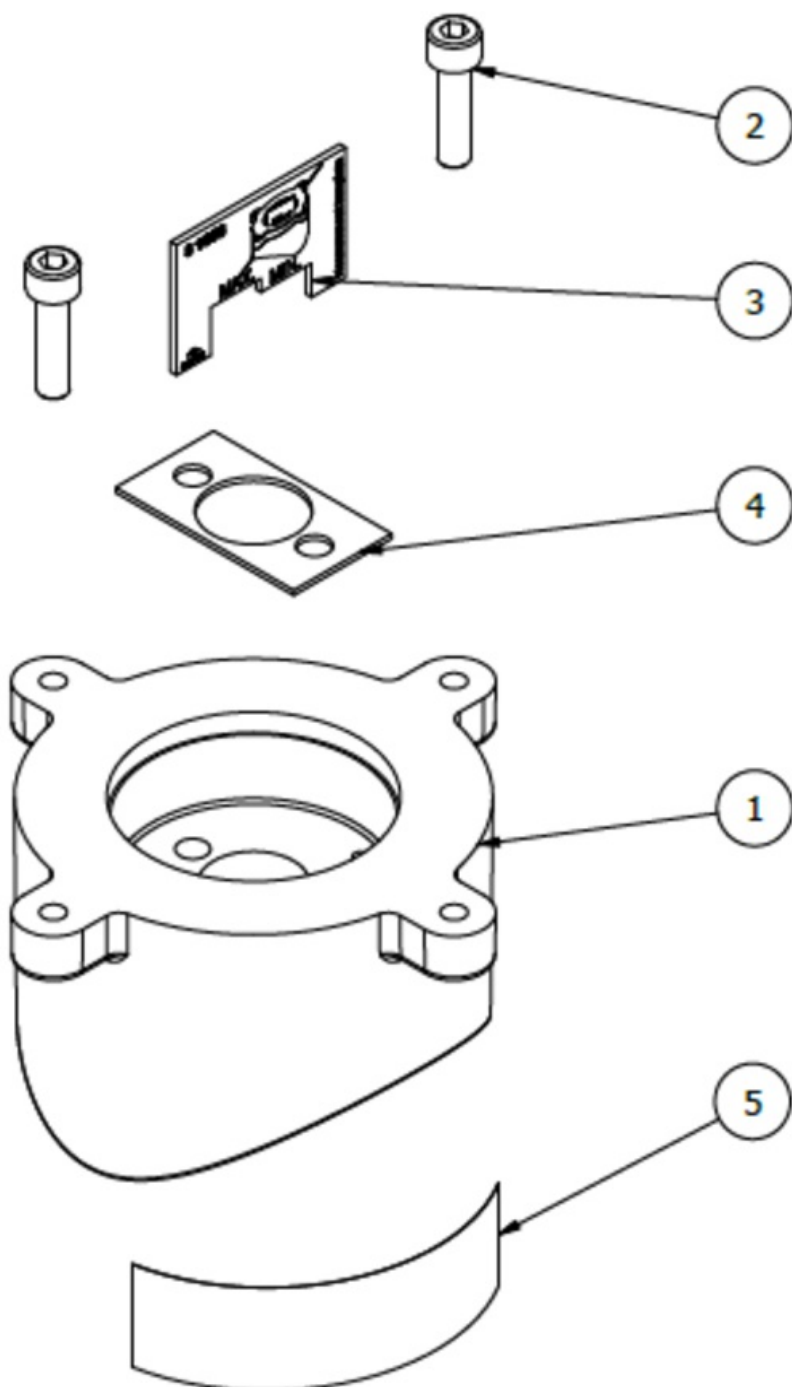

#	Name	Item Code	Description
1	Bracket		SM-126591 - Motor bracket SE30/40
2	Bolt		6 1360 - DIN 912 - M8 x 30
3	Measurement template		3 1856 - Measurement template
4	Support plate		3 1241 - Support plate for motor bracket
5	Label		4 8570 - Label motor bracket

The installer alone has responsibility for the installation of the spare parts. Side-Power only warranty the spare parts supplied only.

The information given in the document was correct at the time it was published. However, Sleipner Motor AS can not accept liability for any inaccuracies or omissions it may contain. Continuous product improvement may change the product specifications without notice. Therefore, Sleipner Motor AS can not accept liability for any possible differences between product and document.