

4 0135

Solenoid bracket kit SE60 + SP55

Spare parts (valid from 2022-03-15)



SLEIPNER

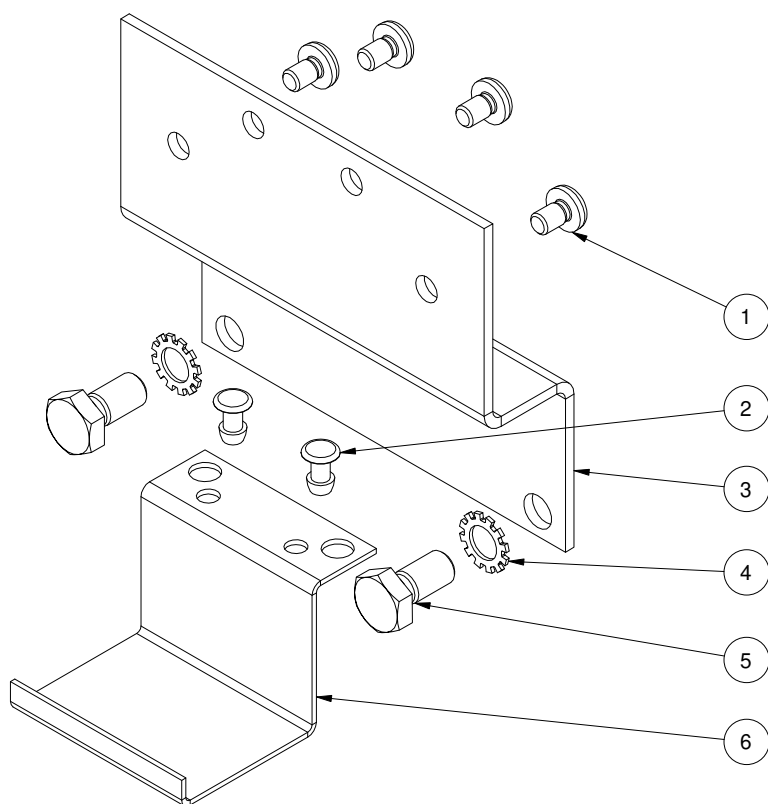

#	Quantity	Name	Item Code	Description
1	4.00	Bolt		ISO 7045 - M4 x 6 (A4)
2	2.00	Blind rivet		DIN 7337 - A3,2 x 8 (A2)
3	1.00	Bracket	4 2033	Solenoid bracket SE60
4	2.00	Spring washer		DIN 6798 - A 6,4 (A4)
5	2.00	Bolt		DIN 933 - M6 x 12 (A2)
6	1.00	Fastening clip	4 2043	Fastening clip

The installer alone has responsibility for the installation of the spare parts. Side-Power only warranty the spare parts supplied only.

The information given in the document was correct at the time it was published. However, Sleipner Motor AS can not accept liability for any inaccuracies or omissions it may contain. Continuous product improvement may change the product specifications without notice. Therefore, Sleipner Motor AS can not accept liability for any possible differences between product and document.