

7 1190 A

Anode, aluminium SE60/80/100

Spare parts (valid from 2022-03-15)



SLEIPNER

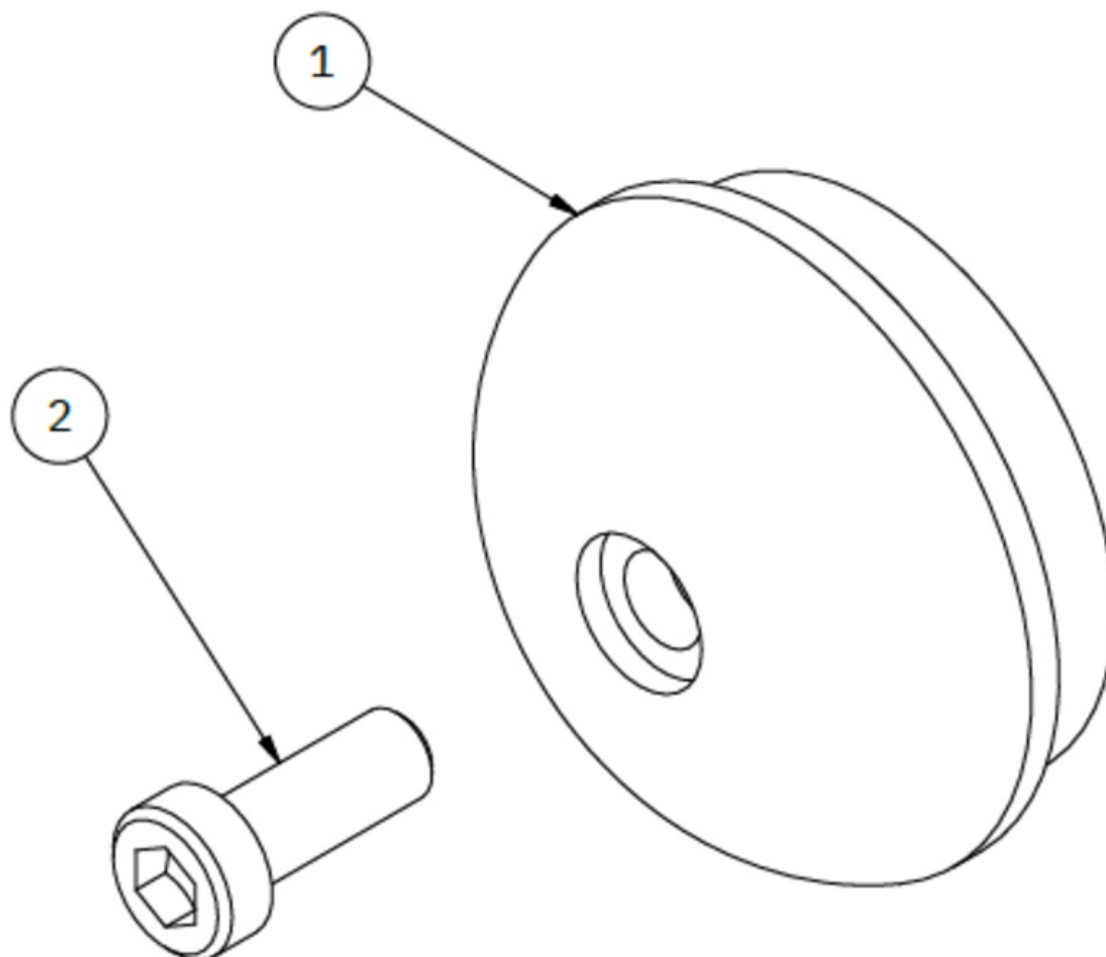

#	Quantity	Name	Item Code	Description
1	1.00	Anode, aluminium	7 9998	Anode, aluminium SE60/80/100
2	1.00	Bolt - DIN 6912 - M6 x 16		--

The installer alone has responsibility for the installation of the spare parts. Side-Power only warranty the spare parts supplied only.

The information given in the document was correct at the time it was published. However, Sleipner Motor AS can not accept liability for any inaccuracies or omissions it may contain. Continuous product improvement may change the product specifications without notice. Therefore, Sleipner Motor AS can not accept liability for any possible differences between product and document.