

90150I

Tunnel kit for stern thruster

SE130/170/210 + SH240, Ø250mm

Spare parts (valid from 2022-06-30)

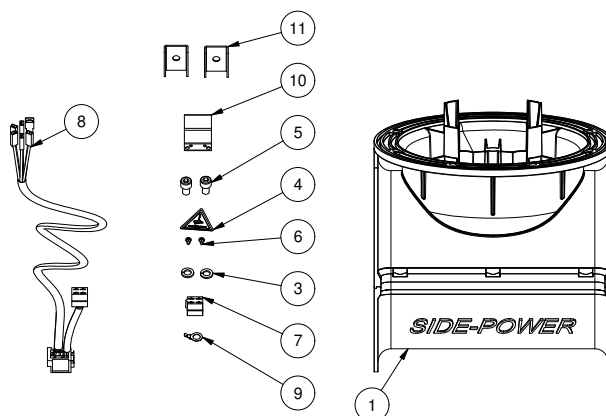

#	Quantity	Name	Item Code	Description
1	1.00	Stern tunnel	SM155412	Composite sternthruster tunnel Ø250
3	2.00	Washer		DIN 127 - A 10
4	1.00	Label		Merkelapp stor trekant
5	2.00	Bolt		DIN 912 - M10 x 16
6	2.00	Screw		DIN7881 - 4,2 x 9,5 A2
7	1.00	Cable lug		Cable lugs 408-4-M
8	1.00	Cable		Kabel m/kontakt forsinkelse "i"
9	1.00	Cable lug		Kontakt
10	1.00	Relay Clip		Relay Clip
11	2.00	Clamps for stern tunnel		Klammer hekkunnel

The installer alone has responsibility for the installation of the spare parts. Side-Power only warranty the spare parts supplied only.

The information given in the document was correct at the time it was published. However, Sleipner Motor AS can not accept liability for any inaccuracies or omissions it may contain. Continuous product improvement may change the product specifications without notice. Therefore, Sleipner Motor AS can not accept liability for any possible differences between product and document.